



Transport for NSW

# Manly Cove

Concept Design | December 2021



Manly Cove drone shot

Manly Cove is an iconic and locally significant place. People and vessels have been part of Manly accessing the Cove by sea for centuries and continue to do so.

Transport for NSW is carrying out two separate projects in Manly Cove, as part of the \$205 million NSW Government stimulus funding for maritime infrastructure and safety upgrades to improve the accessibility to and along the Cove for all of the community including those with assisted and unassisted mobility needs. The projects involve:

- an upgrade of Manly Wharf 3, and
- work to enhance the area of the former Manly Sea Life site.

## Have your say

We invite you to have your say on these projects. Both projects are on display for community feedback until **5pm Friday 28 January 2022.**

To learn more, visit the project page, view our plans and leave your feedback at [nswroads.work/manly-cove](https://nswroads.work/manly-cove)

email: [manlycove@transport.nsw.gov.au](mailto:manlycove@transport.nsw.gov.au)  
web feedback form on our website



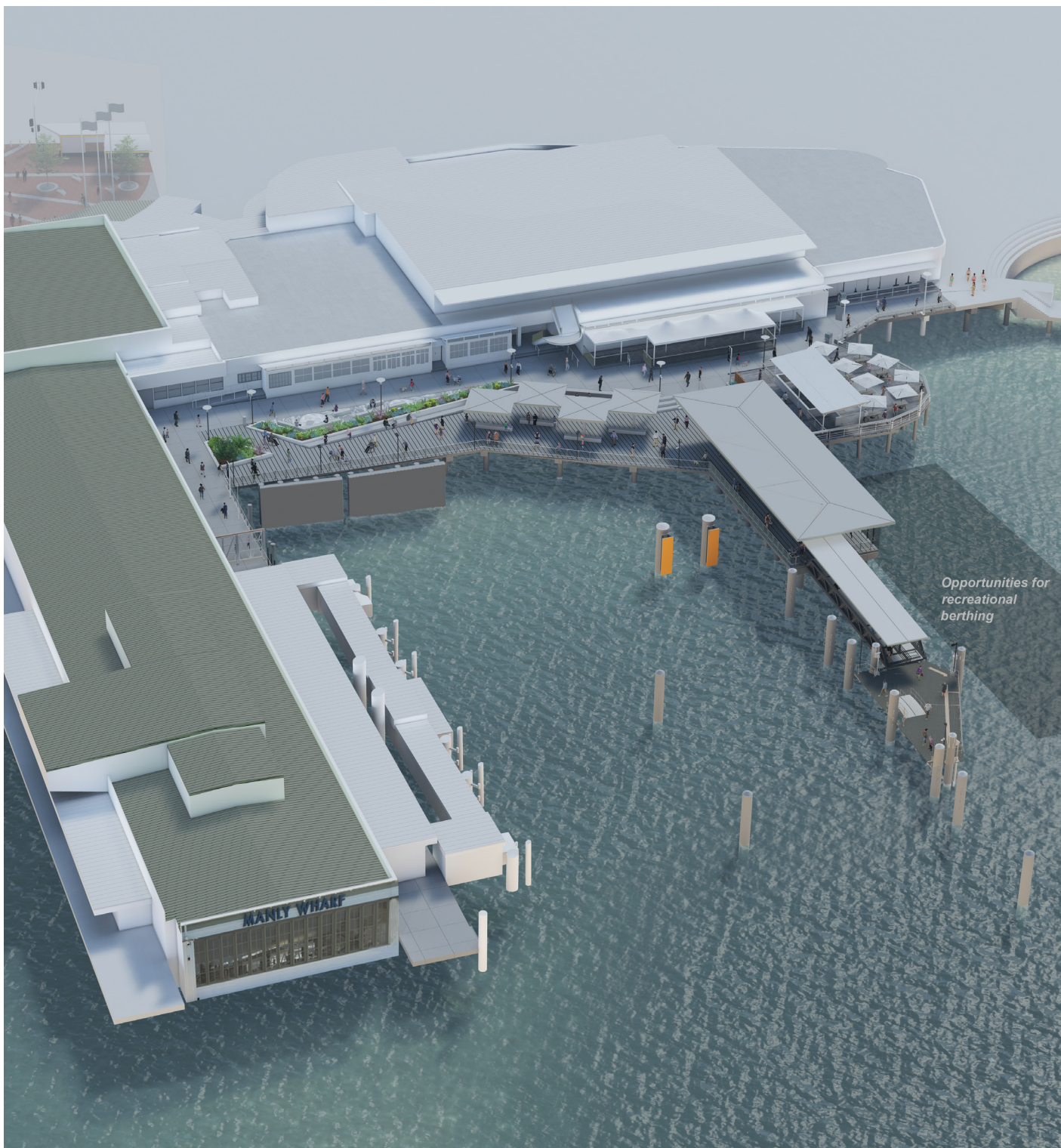

Proposed concept design for Manly Wharf 3 Upgrade

The NSW Government under the Transport Access Program is planning to upgrade Manly Wharf 3, so all customers can safely use the Wharf.

### Manly Wharf 3

Customers with mobility needs currently have difficulty accessing ferry or other commercial services from Manly Wharf 3.

A concept design for a full wharf upgrade has been developed and we are inviting the community and customers to have their say on the suggested changes

# Proposed Concept Design for Manly Wharf 3

Benefits of the upgrade include:

- improved access for mobility impaired customers and customers with prams
- improved customer amenity such as protection from the wind, rain and sun, seating and waiting areas
- improved safety for customers
- quicker and more efficient boarding and disembarking
- improved pedestrian access around the wharf
- more efficient interchange with other modes of public and private transport
- consideration of Manly place making opportunities
- catering for future sea level rise.

## Key design features

Due to the wind and wave movements the proposed Manly Wharf upgrade will include a hydraulic platform with a fixed waiting area, customer seating, weather protection and gangways.

New canopies and roofs will be sympathetic to the heritage precinct and character of the surrounding buildings and maritime landscape.

Ramps and paths would be installed to connect to the nearby interchanges. Most of the existing wharf structure would be removed as part of this proposal.

The proposed Wharf upgrade has been designed to:

- provide accessibility for all customers using the wharf
- improve customer amenities and waiting areas
- improve services for customers and operators using commercial vessels
- cater for sea level rises
- be functional with a respectful design theme that considers the heritage precinct and history of Manly Cove.

While the priority of the NSW Government's Transport Accessibility Program is to provide accessibility for all customers using our public transport network, Transport for NSW has identified an opportunity to plan for the future growth in commercial and recreational vessel usage at Manly Cove.

In the concept design presented for stakeholder and community feedback, we have highlighted an area where recreational and smaller commercial vessel berthing opportunities may be available for inclusion in the final design. We encourage stakeholders and the community to provide suggestions as to how this additional area may be used to maximise recreational and commercial berthing opportunities.

## Environment

We recognise the importance and sensitivity of the local Manly environment. Our proposed design has carefully considered the potential impacts of the construction footprint on the local environment particularly the aquatic ecology.

The impacts will be further assessed as part of the strategic environmental investigations that will shortly commence to support the preparation of the Environmental Impact Assessment for both projects.

The associated impacts of the proposal on the environment and our approach to mitigate and minimise these impacts will be detailed in the environmental assessment.

The community will have an opportunity to review the environmental assessment and provide a submission as part of its public display, which is expected to occur in the first half of 2022.

## Construction

We are committed to minimising impacts and disruption to customers, businesses, and the community during the proposed works.

More information and the opportunity to provide feedback on the construction of the proposed upgrade will be provided as part of the Environmental Impact Assessment consultation process.

Construction of the Manly Wharf 3 is expected to start in 2023 (subject to funding), which would take up to eight months to complete based on previous wharf upgrades.

## Accessible Public Transport

The Transport Access Program is an initiative to provide a better experience for public transport customer by delivering accessible, modern, secure and comfortable transport that connect with other transport infrastructure. It is a legal requirement that all public transport infrastructure, including wharves, have fully compliant disability access by December 2022.

# Key features of proposed Manly Wharf 3 Upgrade

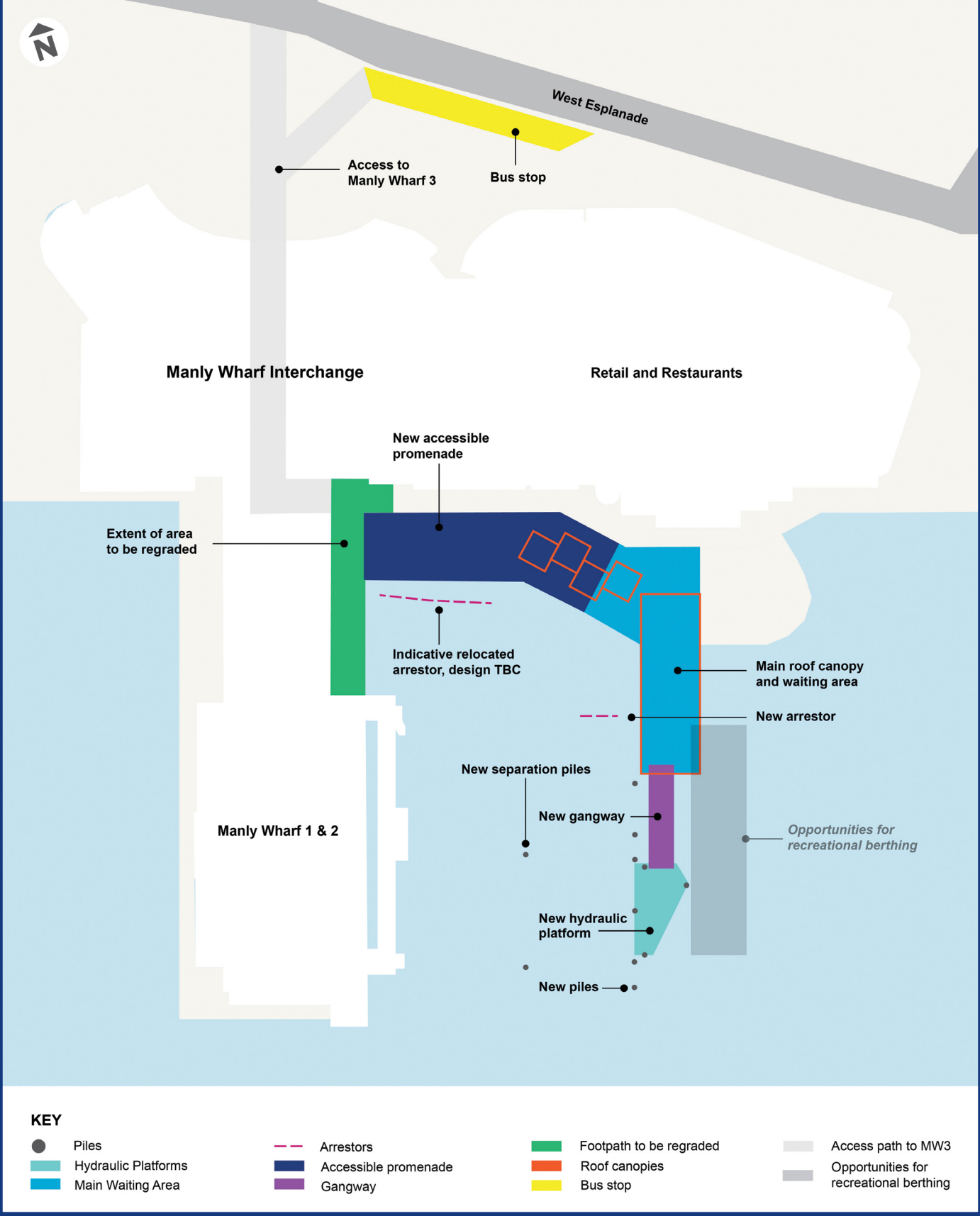





Artist's impression (indicative only – subject to design development and consultation)

## Former Manly Sea Life site

Transport for NSW is the owner of the former aquarium Manly Sea Life and the Manly Pavilion.

Since the Sea Life aquarium building was closed in 2018, it has remained vacant and is not fit for reuse. The aquarium building is dilapidated, and it still houses custom built tanks and enclosures not easily adapted to a future new use. The building also blocks sight lines to the heritage buildings behind.

Transport recognises the importance of creating a place, which respects the local cultural heritage, connects people to land and water and creates a prominent waterfront location in Manly.

We would like to enhance the Manly West Esplanade precinct area and reconnect the Pavilion and heritage buildings with the beach by removing the aquarium building and extending the boardwalk with enough width for outdoor dining and a recreational edge. This proposal would provide a safe, family friendly for the West Esplanade area, which maintains and celebrates the local heritage of the area.

There is also the opportunity to improve public waterfront access with the possibility of the inclusion of a wharf structure for pick up and drop off of recreational vessels. We are seeking your feedback on our plans and potential uses for the site.

## Recreational Berthing opportunities at Manly Cove

Transport for NSW has identified an opportunity to include designated recreational drop up and pick up zones within Manly Cove.

We are seeking your feedback about where and what the designs for recreational drop off zones could look like.

## We invite you to come and meet the team where you may ask questions and learn more about the proposed projects.

**When:** Monday 20 December 2021 between 8am and 11am.

Tuesday 21 December 2021 between 8am and 11am.

We will also be holding some further sessions in the same location on Thursday 20 and Friday 21 January 2022 between 8am and 11am.

Social distancing measures will be in place to protect the safety of our staff and the community, we ask you to respect these measures when you visit our team.

## Next steps

Transport will be working on these projects concurrently, to minimise disruption and so that Manly Cove continues to support the local community and those who wish to visit to work, rest or play.

### Manly Wharf 3

We will consider all feedback received during the public display of the concept design for Manly Wharf 3.

Feedback will be considered in the refinement of the design and during the development of the Environmental Impact Assessment.

The community will be able to provide further feedback on the environmental impacts when the Environmental Impact Assessment is placed on public display in the first half of 2022.

### Former Manly Sea Life site

We will consider all feedback in line with our plans for the site. In 2022, we will review feedback received and carry out further investigations around the proposed site to support the development of the Environmental Impact Assessment.

Our office will be closed from the 25 December 2021 to 10 January 2022.

## Contact us

If you have any questions, would like more information about this project or to subscribe for updates please contact the project team:

 1800 770 973 (during business hours)

 [manlycove@transport.nsw.gov.au](mailto:manlycove@transport.nsw.gov.au)

 [nswroads.work/manly-cove](https://nswroads.work/manly-cove)



If you require the services of an interpreter, please contact the Translating and Interpreting Service on 131 450 and ask them to call the project team on 02 6923 6664.

December 2021



**Privacy Transport for NSW ("TfNSW")** is subject to the Privacy and Personal Information Protection Act 1998 ("PPIP Act") which requires that we comply with the Information Privacy Principles set out in the PPIP Act. All information in correspondence is collected for the sole purpose of assisting in the delivery of this project. The information received, including names and addresses of respondents, may be published in subsequent documents unless a clear indication is given in the correspondence that all or part of that information is not to be published. Otherwise Transport for NSW will only disclose your personal information, without your consent, if authorised by the law. Your personal information will be held by Transport for NSW at 27 Argyle Street, Parramatta. You have the right to access and correct the information if you believe that it is incorrect.